

CC-17/ WT-17

Quick Reference guide

I How to use the CC-17/WT-17

■ Carrying Case CC-17

You can work as soon as you open the CC-17.



■ Working tray WT-17

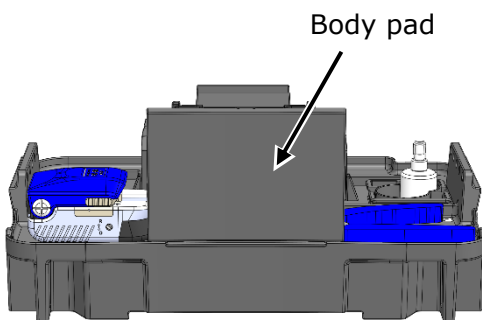

1. Attach the body pad to the tray.

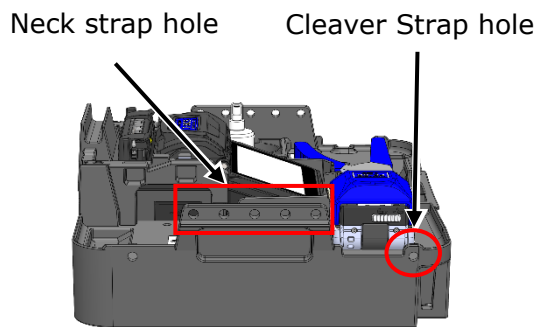

2. Hook the strap in one of the strap holes as highlighted in red in the above figure.



3. Place the strap around your neck.

■ Other convenient functions



Tripod



Upper stack

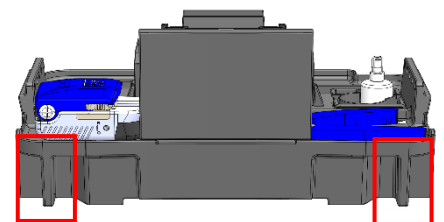

Waist belt

I How to take out/attach the fusion splicer to WT-17

This page describes how to remove/attach the fusion splicer to WT-17.

■ How to take out the fusion splicer



1. While holding the fusion splicer, pull the lever.

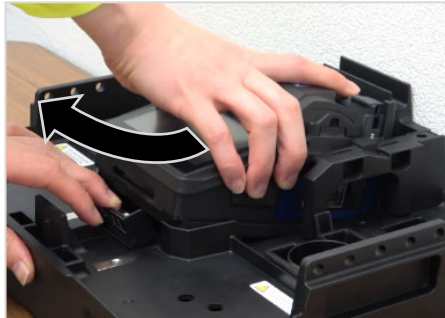

2. Lift the fusion splicer while pulling the lever.



3. Remove the fusion splicer towards you while pulling the lever.

■ How to attach the fusion splicer

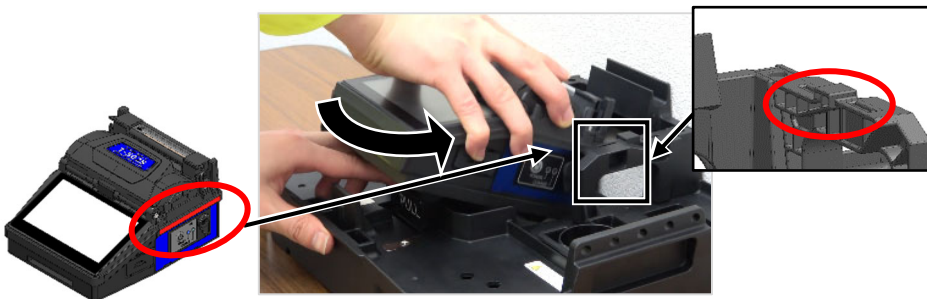

1. As shown in the picture left, install the fusion splicer by passing the red-lined section under the red-circled protrusion.



2. Pull the lever and place the fusion splicer on the WT-17 properly.



3. Try to move the splicer after it is locked in place to ensure it is fully secured to the WT-17.

Make sure the splicer is properly secured.



NG
The splicer is lifted as it is attached in a wrong way.



NG
The splicer is shaky as it is not locked properly.



Caution

If the fusion splicer is not securely attached to the WT-17, it may fall.

